

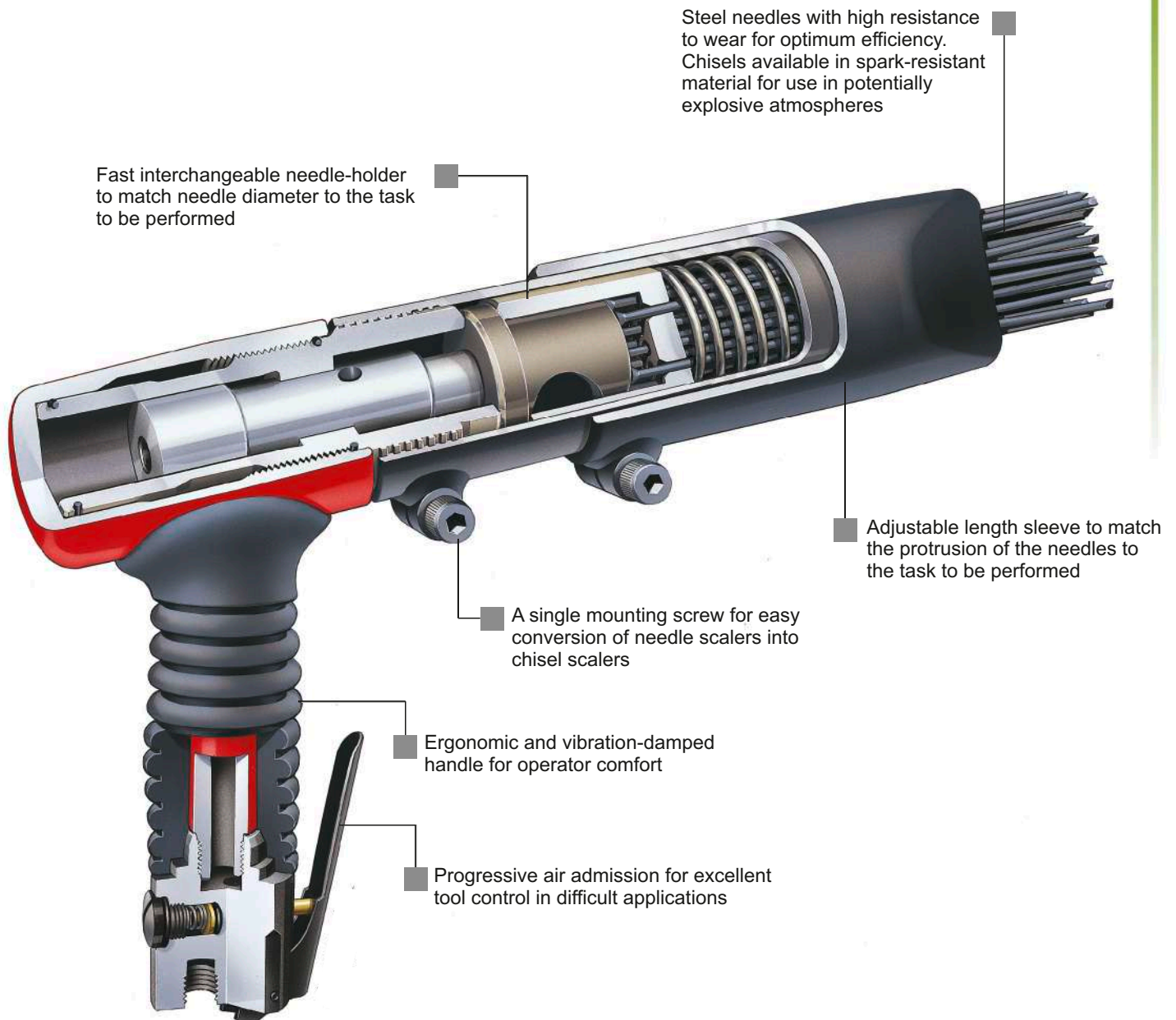

Needle Scalers, Chippers and Chisel Scalers

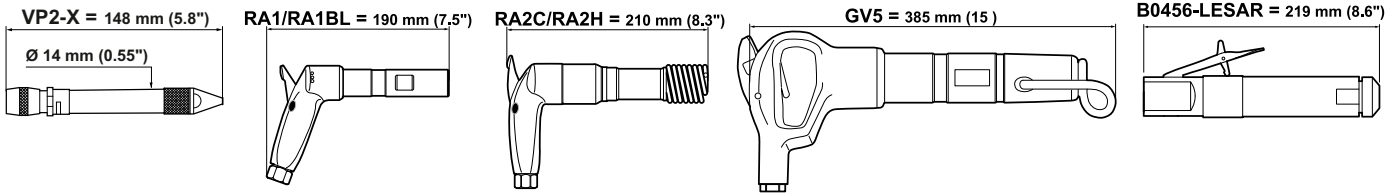

Accessories



VP2-X / RA1(BL) / RA2C(H) / GV5 / B0456

ACCESSORIES INCLUDED

ITEM	VP2-X	RA1 / RA2	B0456
• Air Hose - 3.2mm bore - Length 2m (78.7") - 1/8" - 1/4" BSP	75902		
• Tungsten carbide tipped needle	63213		
• Key	63533		
• 1/4" air hose nipple for 10mm (3/8") ID hose		615 705 006 0	
• Sealing chisel			P084376

OPTIONAL ACCESSORIES

Shank \varnothing 9.5 x 9mm (3/8" x 23/64")

ITEM	RA1	RA1 BL
1 Chisel, width 9mm (23/64"), length 150mm (529/32")	615 040 115 0	
2 Chisel, \varnothing 6mm (15/64"), length 250mm (927/32")	615 804 437 0	
3 Flat chisel, 3mm (1/8"), length 250mm (927/32")	615 804 438 0	
4 Chisel thickness, 6mm (15/64"), length 145mm (545/64")		615 041 114 0
4 Chisel thickness, 6mm (15/64"), length 200mm (77/8")		615 041 120 0

Shank 126 - \varnothing 15 x 55mm (19/32" x 211/64")

ITEM	RA2C
5 Chisel, width 16mm (5/8"), length 185mm (79/32")	615 045 118 0
5 Chisel, width 16mm (5/8"), length 250mm (927/32")	615 804 088 0
6 Pick, length 185mm (79/32")	615 045 218 0

Shank 122 - Hex 12.5 x 55mm (8/16" x 211/64")

ITEM	RA2H
7 Chisel, width 16mm (5/8"), length 185mm (79/32")	615 046 118 0
7 Chisel, width 16mm (5/8"), length 250mm (927/32")	615 804 089 0
7 Chisel, width 16mm (5/8"), length 310mm (1213/64")	615 804 431 0
7 Chisel, width 16mm (5/8"), length 500mm (1911/16")	615 804 090 0
8 Chisel*, width 24mm (15/16"), length 310mm (1213/64")	615 804 440 0*
8 Chisel*, width 50mm (131/32"), length 250mm (927/32")	615 804 421 0*
*Supplied with retaining spring 615 690 089 0 (former TR0289)	
9 Blank tool, length 175mm (627/64")	615 046 017 0
9 Blank tool, length 240mm (929/64")	615 046 024 0
10 Pick, length 185mm (79/32")	615 046 218 0
10 Pick, length 250mm (927/32")	615 804 092 0
11 Blade cutter, length 200mm (77/8")	615 046 920 0

Hex. shank 19.2 x 50mm (3/4" x 131/32")

ITEM	GV5
12 Chisel, width 19mm (3/4"), length 300mm (1115/16")	615 804 095 0
12 Chisel, width 19mm (3/4"), length 500mm (1911/16")	615 804 096 0
13 Pick, length 300mm (1115/16")	615 804 093 0
13 Pick, length 500mm (1911/16")	615 804 094 0
14 Scraper, width 60mm (223/64"), length 250mm (927/32")	615 804 097 0

Shank: Qtr. Oct WF 1/2" (B0456)

ITEM	B0456
15 Flat Chisel, 15.9mm (5/8") face, length 191mm (71/2")	P073225
15 Flat Chisel, 35mm (13/8") face, length 102mm (4")	P072213
15 Flat Chisel, 35mm (13/8") face, length 229mm (9")	P084175
15 Flat Chisel, 35mm (13/8") face, length 305mm (12")	P084176
15 Flat Chisel, 35mm (13/8") face, length 457mm (18")	P084177
15 Flat Chisel, 44mm (13/4") face, length 213mm (53/8")	P070982
• Angle Scaling, 35mm (13/8") face, length 165mm (61/2")	P084376
16 Cape 6.4mm (1/4") face length 191mm (71/2")	P073224
17 Diamond Pt. 6.4mm (1/4") face length 191mm (71/2")	P073223

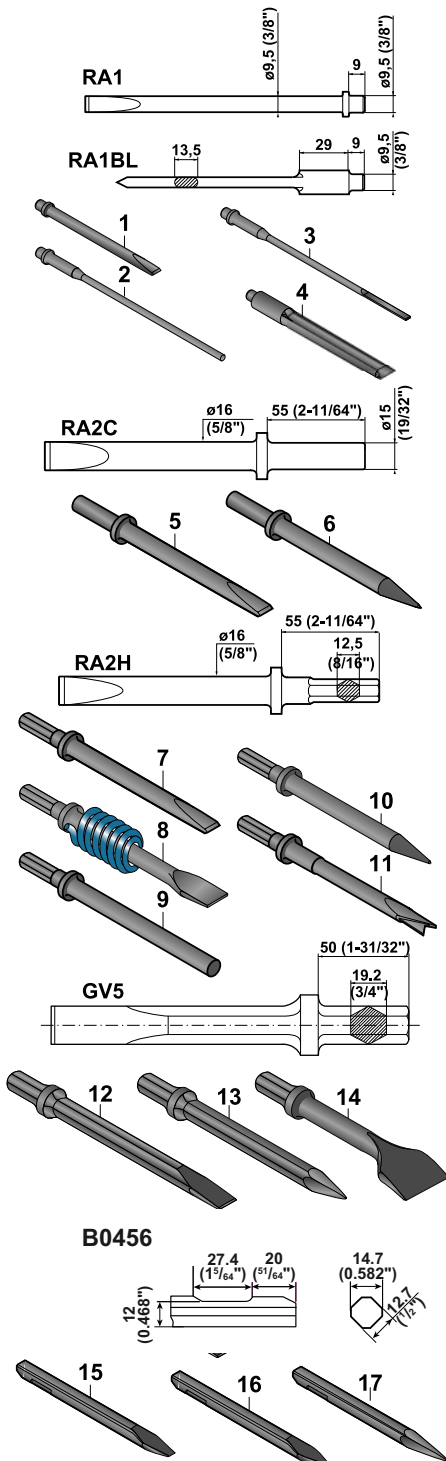

Air Scribe, Chisel Scalars and Weld Flux Chipper



All models: supplied without chisel, except for B0456

PIC REF	MODEL	PART NUMBER	BORE & STROKE		SHANK	BLOWS PER MINUTE	WEIGHT		AIR CONSUMPTION AT FREE SPEED		AIR INLET THREAD		HOSE INT. Ø	
			mm	in.			kg	lb.	l/s	cfm	in.	mm	in.	
AIR SCRIBE														
A	VP2-X	671094	-	-	-	11400	0.1	0.2	0.9	1.9	1/8	3.2	1/8	
CHISEL SCALERS														
B	RA1	615 174 018 0	13 x 45	0.51 x 1.77	Round	4000	1.1	2.4	3.0	7.0	1/4	10	3/8	
B	RA1 BL	615 174 019 0	13 x 45	0.51 x 1.77	Flatnosed	4000	1.1	2.4	3.0	7.0	1/4	10	3/8	
C	RA2C	615 174 020 0	18 x 58	0.71 x 2.28	126	3500	2.0	4.4	4.6	9.7	1/4	10	3/8	
C	RA2H	615 174 021 0	18 x 58	0.71 x 2.28	122	3500	2.0	4.4	4.6	9.7	1/4	10	3/8	
PNEUMATIC HAMMER														
D	GV5	615 174 017 0	28 x 52.5	1.1 x 2.07	19 x 50	2400	5.1	11.2	8.3	17.6	1/2	13	1/2	
WELD FLUX CHIPPER														
E	B0456-LESAR	T013046	23.8 x 25.4	15/16 x 1.0	Qtr. Oct WF 1/2"	4300	1.6	3.5	4.7	10.0	1/4	10	3/8	

Accessories

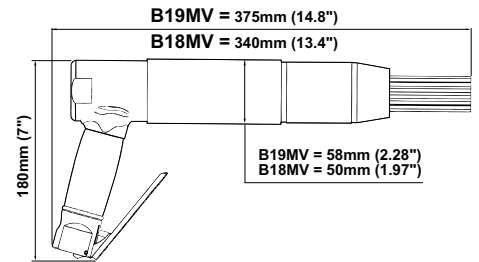
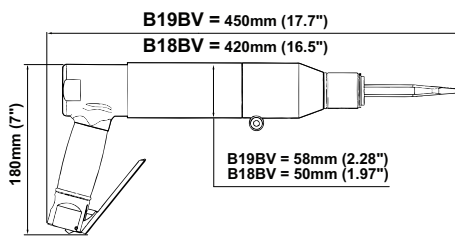
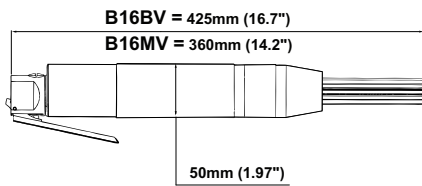

B16MV / B18MV / B19MV

ACCESSORIES INCLUDED

- Hex. Key 6mm
- 1/4" air hose nipple for 10mm (3/8") ID hose

PART NO.

615 802 056 0

OPTIONAL ACCESSORIES

ITEM	PART NO.
1 Chisel tip needles, \varnothing 3mm (1/8"), length 178mm (7") (Qty 100)	615 399 819 0
1 Chisel tip needles, \varnothing 4mm (5/32"), length 178mm (7") (Qty 100)	615 399 820 0
2 Flat tip needles, \varnothing 2mm (5/64"), length 178mm (7") (Qty 100)	615 399 816 0
2 Flat tip needles, \varnothing 3mm (1/8"), length 178mm (7") (Qty 100)	615 399 817 0
2 Flat tip needles, \varnothing 4mm (5/32"), length 178mm (7") (Qty 100)	615 399 818 0
3 Pointed tip needles, \varnothing 3mm (1/8"), length 178mm (7") (Qty 100)	615 399 821 0
3 Pointed tip needles, \varnothing 4mm (5/32"), length 178mm (7") (Qty 100)	615 399 822 0

B16BV / B18BV / B19BV

ACCESSORIES INCLUDED

- Hex. Key 6mm
- 1/4" air hose nipple for 10mm (3/8") ID hose

- 1 Chisel, width 19mm (3/4"), length 178mm (7") for B18BV & B19BV
- 2 Angle chisel, width 35mm (1 3/8"), length 178mm (7") for B16BV

PART NO.

615 802 056 0

615 804 618 0

615 804 622 0

OPTIONAL ACCESSORIES

ISO 1/2" Square Shank Chisels

ITEM	PART NO.
1 Chisel, width 19mm (3/4"), length 178mm (7")	615 804 618 0
2 Angle chisel, width 35mm (1 3/8"), length 178mm (7")	615 804 622 0
3 Chisel, width 64mm (2 1/2"), length 178mm (7")	615 804 619 0
4 Chisel, width 19mm (3/4"), length 254mm (10")	615 804 620 0
5 Chisel, width 50mm (2"), length 178mm (7")	615 804 621 0

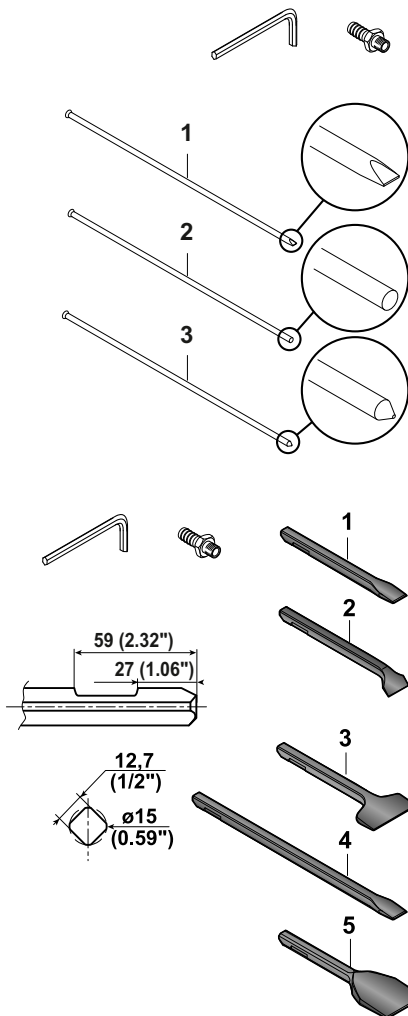

Vibration-Damped Chippers and Needle Scalers



A

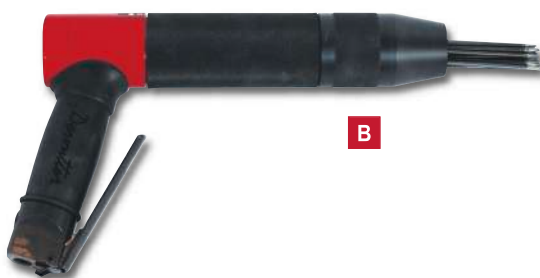

B

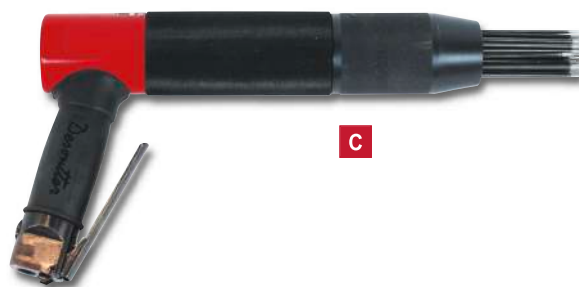

C



D



E



F

*B16BV Hammer is delivered with an angle chisel and B18BV / B19BV Hammers are delivered with standard straight chisel
All Needle Scalers are delivered with Chisel Tipped needles.*

PIC REF	MODEL	PART NUMBER	BORE & STROKE		NEEDLE / CHISEL CAPACITY	BLOWS PER MINUTE	WEIGHT		AIR CONSUMPTION AT FREE SPEED		AIR INLET THREAD	HOSE INT. Ø	
			mm	in.			kg	lb.	l/s	cfm		in.	mm
VIBRATION-DAMPED NEEDLE SCALERS													
A	B16MV	615 174 050 0	23.5 x 11	0.92 x 0.43	19 x 3 (1/8)	2 400	2.4	5.3	2.4	5.1	1/4	10	3/8
B	B18MV	616 174 052 0	23.5 x 11	0.92 x 0.43	19 x 3 (1/8)	2 400	2.7	5.9	2.0	4.2	1/4	10	3/8
C	B19MV	618 174 054 0	34.4 x 20	1.35 x 0.79	28 x 3 (1/8)	3 000	3.6	7.9	2.1	4.4	1/4	10	3/8
VIBRATION-DAMPED CHIPPERS													
D	B16BV	615 174 051 0	23.5 x 11	0.92 x 0.43	1/2" Square	2 400	2.8	6.2	2.4	5.1	1/4	10	3/8
E	B18BV	615 174 053 0	23.5 x 11	0.92 x 0.43	1/2" Square	2 400	3.1	6.8	2.0	4.2	1/4	10	3/8
F	B19BV	617 174 055 0	34.4 x 20	1.35 x 0.79	1/2" Square	3 000	4.1	9.0	2.1	4.4	1/4	10	3/8

Accessories

B15B = 201 mm (7.91")
B16B = 231 mm (9.09")

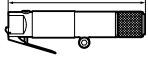

B18B = 173 mm (6.81")

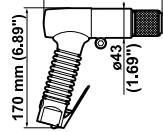

B19B = 191 mm (7.52")

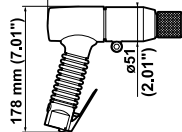

B19B-1 = 218 mm (8.58")

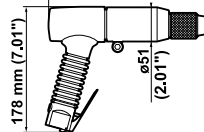

B21B = 310 mm (12.20")

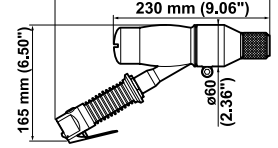

B15B / B16B / B18B / B19B / B19B1 / B21B

ACCESSORIES INCLUDED

- Hex. Key 6mm (1/4")
- 1/4" air hose nipple for 10mm ID hose

PART NO.
615 802 056 0

OPTIONAL ACCESSORIES

ISO 1/2" Square Shank Chisels

ITEM	B15B / B16B B18B / B19B / B21B
1 Chisel, width 19mm (3/4"), length 180mm (7")	615 804 443 0
2 Angle chisel, width 35mm (1 3/8"), length 180mm (7")	615 804 444 0
3 Chisel, width 60mm (3 23/64"), length 180mm (7")	615 804 445 0
4 Spark-resistant chisel, width 50mm (1 31/32")	615 003 900 0
5 Chisel, width 6mm (1/4"), length 180mm (7") for brick joints	615 804 062 0
6 Flat Chisel, 15.9mm (5/8") face, length 191mm (7 1/2")	P073225
6 Flat Chisel, 35mm (1 3/8") face, length 102mm (4")	P072213
6 Flat Chisel, 35mm (1 3/8") face, length 229mm (9")	P084175
6 Flat Chisel, 35mm (1 3/8") face, length 305mm (12")	P084176
6 Flat Chisel, 35mm (1 3/8") face, length 457mm (18")	P084177
6 Flat Chisel, 44mm (1 3/8") face, length 213mm (5 3/8")	P070982
7 Cape 6.4mm (1/4") face length 191mm (7 1/2")	P073224
8 Diamond Pt. 6.4mm (1/4") face length 191mm (7 1/2")	P073223

Hex. Shank 5/8" Chisels

ITEM	B19B1
9 Chisel, width 100mm (3 15/16"), length 180mm (7")	615 804 441 0
10 Chisel, width 50mm (1 31/32"), length 180mm (7")	615 804 442 0
11 Spark-resistant chisel, width 50mm (1 31/32")	615 002 900 0
12 Scaling tool, width 100mm (3 15/16")	615 002 901 0
13 Scaling tool, width 200mm (7 7/8")	615 002 902 0
14 Comb-type chisel, width 38mm (1 1/2"), length 180mm (7")	615 002 903 0
15 Spare blade, width 100mm (3 15/16") (Qty 5)	615 250 527 0
16 Spare blade, width 200mm (7 7/8") (Qty 5)	615 250 528 0
17 Spare comb, width 38mm (1 1/2")	615 250 539 0

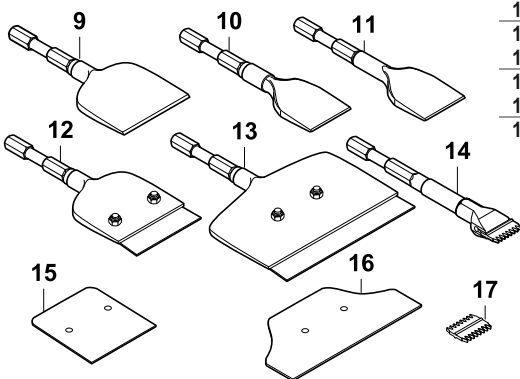
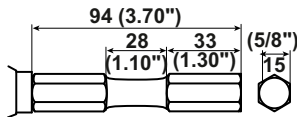
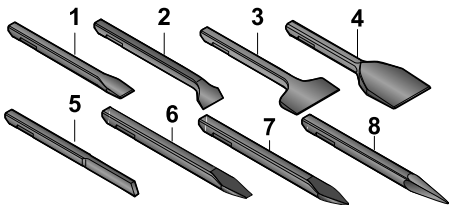
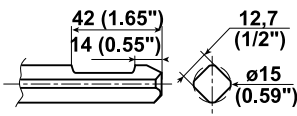

Chippers - Chisel Scalers



A



B



C



D



E

All models: Supplied without chisel

PIC REF	MODEL	PART NUMBER	BORE & STROKE		SHANK	BLOWS PER MINUTE	WEIGHT		AIR CONSUMPTION AT FREE SPEED		AIR INLET THREAD	HOSE INT. Ø	
			mm	in.			kg	lb.	l/s	cfm		in.	mm
A	B15B	615 174 023 0	18.0 x 30.0	0.71 x 1.18	ISO 1/2 square	3800	1.5	3.3	1.4	3.0	1/4	8	5/16
A	B16B	615 174 025 0	23.5 x 35.6	0.92 x 1.40	ISO 1/2 square	3000	2.0	4.4	2.6	5.5	1/4	10	3/8
B	B18B	615 174 027 0	23.5 x 35.6	0.92 x 1.40	ISO 1/2 square	3000	2.0	4.4	2.6	5.5	1/4	10	3/8
C	B19B	615 174 030 0	28.6 x 39.0	1.12 x 1.53	ISO 1/2 square	2200	3.0	6.6	3.8	8.0	1/4	10	3/8
D	B19B1	615 174 031 0	28.6 x 39.0	1.12 x 1.53	Hex. 5/8	2200	3.0	6.6	3.8	8.0	1/4	10	3/8
E	B21B	615 174 040 0	33.0 x 49.2	1.30 x 1 ¹⁵ / ₁₆	ISO 1/2 square	2200	4.0	8.8	4.0	8.5	1/4	10	3/8

Accessories

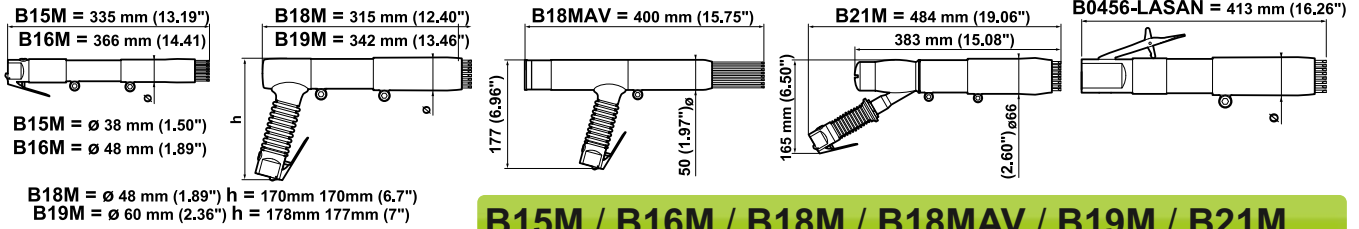

B15M / B16M / B18M / B18MAV / B19M / B21M

ACCESSORIES INCLUDED

- Hex. Key 6mm
- 1/4" air hose nipple for 10mm (3/8") ID hose

PART NO.
615 802 056 0

OPTIONAL ACCESSORIES

ITEM	B15M	B16M/B18M
1 1/2" square tool retainer	615 250 524 0	615 250 525 0
2 Round adjustable sleeve	615 250 523 0	615 250 515 0
3 Needle holder for 29 needles \varnothing 2mm (5/64")	615 250 531 0	
3 Needle holder for 51 needles \varnothing 2mm (5/64")		615 250 532 0

OPTIONAL ACCESSORIES

ITEM	B19M	B21M
4 1/2" square tool retainer	615 250 538 0	615 250 536 0
5 5/8" hex. tool retainer	615 250 526 0	
6 Round adjustable sleeve	615 250 519 0	615 250 535 0
7 Needle holder for 19 needles \varnothing 4mm (5/32")	615 250 533 0	
7 Needle holder for 65 needles \varnothing 2mm (5/64")	615 250 543 0	
7 Needle holder for 49 needles \varnothing 3mm (1/8")		615 250 537 0

Needles Sets - for all Models

8 Chisel tip needles, \varnothing 3mm (1/8"), length 178mm (7") (Qty 100)	615 399 819 0
9 Flat tip needles, \varnothing 2mm (5/64"), length 178mm (7") (Qty 100) except for B18MAV	615 399 816 0
9 Flat tip needles, \varnothing 3mm (1/8"), length 178mm (7") (Qty 100)	615 399 817 0
9 Flat tip needles, \varnothing 4mm (5/32"), length 178mm (7") (Qty 100) except for B18MAV	615 399 818 0
10 Pointed tip needles, \varnothing 3mm (1/8"), length 178mm (7") (Qty 100)	615 399 821 0
10 Pointed tip needles, \varnothing 4mm (5/32"), length 178mm (7") (Qty 100) except for B18MAV	615 399 822 0

B0456

OPTIONAL ACCESSORIES

ITEM	B0456-LASAN
1 Round Nose	P103105

Needles Sets

• Steel needle set, \varnothing 3mm (1/8"), length 178mm (7") Qty. 19	P100146
• Steel needle set, \varnothing 2mm (5/64"), length 178mm (7") Qty. 29	NP123905
• Steel needle set, \varnothing 2mm (5/64"), length 178mm (7") Qty. 53	NP123906
• Steel needle set, \varnothing 3mm (1/8"), length 127mm (5") Qty. 19	P136403
• Steel needle set, \varnothing 3mm (1/8"), length 178mm (7") Qty. 12	NP123901
• Steel needle set, \varnothing 3mm (1/8"), length 178mm (7") Qty. 23	NP123902
• Steel needle set, \varnothing 3mm (1/8"), length 178mm (7") Qty. 28	NP123903
• Steel needle set, \varnothing 3mm (1/8"), length 178mm (7") Qty. 250	NP137638
• Stainless, needle set, \varnothing 3mm (1/8"), length 178mm (7") Qty. 19	P106454

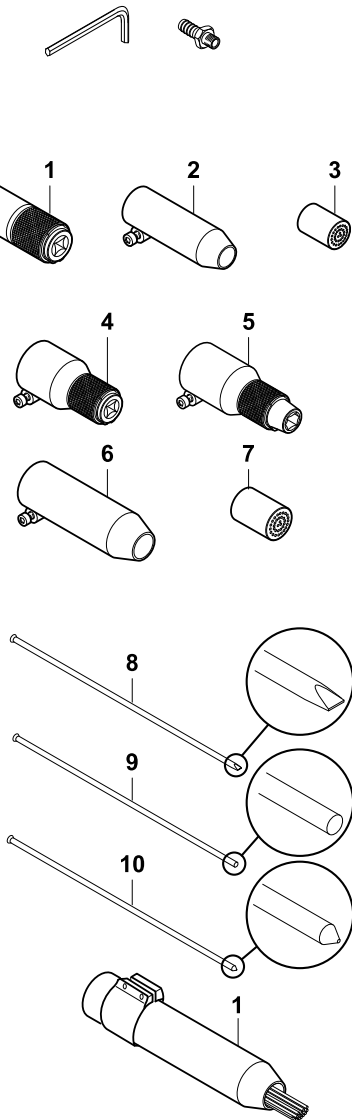

Standard Needle Scalers and Vibration-Damped Needle Scaler



A

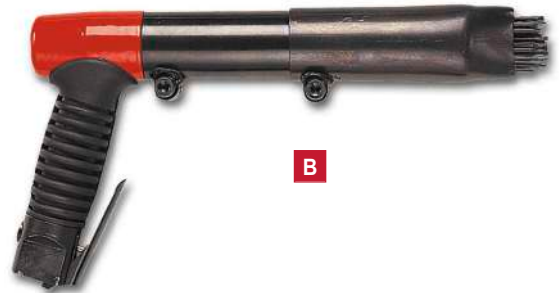

B

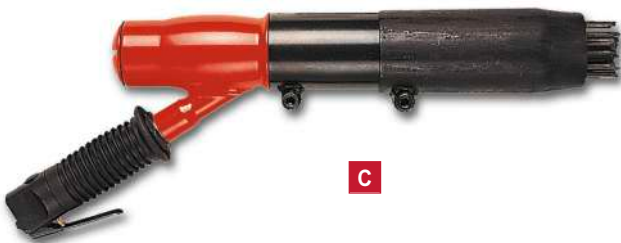

C



D



E

All models: Supplied with chisel tip needles and flatnosed sleeve except for B18MAV & B0456 (round sleeve) and B21M with flat needles.

*Entire needle attachment can be removed from B0456-LASAN.

PIC REF	MODEL	PART NUMBER	BORE & STROKE		NEEDLE CAPACITY No. x \varnothing mm (in.)	BLOWS PER MINUTE	WEIGHT		AIR CONSUMPTION AT FREE SPEED		AIR INLET THREAD		HOSE INT. \varnothing	
			mm	in.			kg	lb.	l/s	cfm	in.	mm	in.	
STANDARD NEEDLE SCALERS														
A	B15M	615 174 024 0	18.0 x 30.0	0.71 x 1.18	12 x 3 (1/8)	3800	1.6	3.5	1.4	3.0	1/4	8	5/16	
A	B16M	615 174 026 0	23.5 x 35.6	0.92 x 1.40	19 x 3 (1/8)	3000	2.6	5.7	2.6	5.5	1/4	10	3/8	
B	B18M	615 174 028 0	23.5 x 35.6	0.92 x 1.40	19 x 3 (1/8)	3000	2.6	5.7	2.6	5.5	1/4	10	3/8	
B	B19M	615 174 032 0	28.6 x 39.0	1.12 x 1.53	28 x 3 (1/8)	2200	3.7	8.2	3.8	8.0	1/4	10	3/8	
C	B21M	615 174 041 0	33.0 x 49.2	1.30 x 1 ¹⁵ / ₁₆	35 x 4 (9/32)	2200	5.6	12.4	4.0	8.5	1/4	10	3/8	
D	B0456-LASAN*	T013049	23.8 x 25.4	1 ⁵ / ₁₆ x 1	19 x 3 (1/8)	4300	2.7	6.0	6.6	13.9	1/4	10	3/8	
VIBRATION-DAMPED NEEDLE SCALER														
E	B18MAV	615 174 029 0	23.5 x 35.6	0.92 x 1.40	19 x 3 (1/8)	3000	3.5	7.7	2.6	5.5	1/4	10	3/8	